

RIVETKING® SBS-CT™ SERIES • “CRIMP STYLE” • MULTIGRIP-CT™

STEEL/STEEL MULTIGRIP™ “CRIMP STYLE”

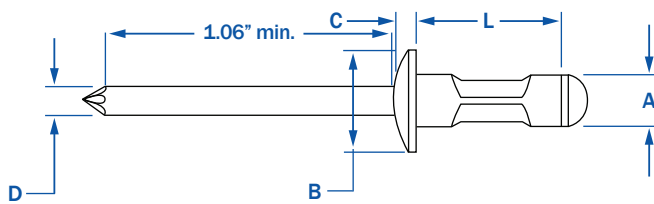

The benefit of a MultiGrip™ is that they offer a wider grip range than traditional blind rivets assisting the users in inventory reduction and part consolidation efforts. The CT series has excellent hole fill ability and strength as compared to standard blind rivets and RT series MultiGrips™. TS-16949 produced and when applicable on steel, trivalent zinc plated for ROHS and GMW3044 compliance.



RIVET: STEEL TRIVALENT ZINC PLATED
MANDREL: STEEL TRIVALENT ZINC PLATED



SPECIAL BLIND RIVETS

HEAD STYLE	PART NUMBER	RIVET SIZE	GRIP RANGE		LENGTH	HEAD DIA	HEAD HEIGHT	MANDREL DIA	HOLE SIZE	SHEAR	TENSILE
			MIN - MAX	MAX							
DOME HEAD	SBS - 41 - 43MG	1/8"	.043 - .250	.355	.283	.033	.057	.129 - .133 (#30)	340	385	
	SBS - 42 - 44MG		.125 - .250	.407							
	SBS - 52 - 53MG	5/32"	.056 - .196	.433	.319	.047	.108	.160 - .164 (#20)	440	530	
	SBS - 62 - 63MG	3/16"	.062 - .187	.405	.386	.069	.133	.192 - .196 (#11)	450	787	
	SBS - 63 - 64MG		.125 - .250	.511							

RIVETKING® QUIKSNAP®

NICKEL PLATED BRASS HEAD/ STAINLESS MANDREL

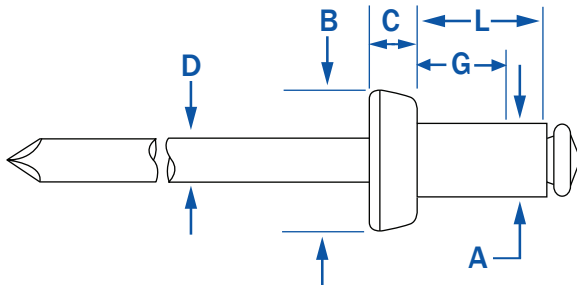

The innovative RivetKing® Quick-Snap™ is the ideal companion to the standard canvas snap used on truck bodies, convertibles, boats, cars and many other applications. The snap head is brass, with a bright nickel plating. The mandrel is stainless steel. Requires T105-734 Nosepiece.

The extract force is a minimum of 5 lbs.

RIVET SIZE	HOLE SIZE AND DRILL NO.	MANDREL DIA. NOM.	FLANGE DIA. NOM.	HEAD HEIGHT MAX.	BARREL LENGTH MAX.	PART NUMBER	GRIP RANGE	TYPICAL ULTIMATE STRENGTH		CARTON	
								SHEAR LBS	TENSILE LBS	QTY. M	WT. LBS
1/8"	.129-.133	.076	.395	.170	.337	B/SS43SH	.020-.087	.260	.310	10	43
3.2	#30				.525	B/SS46SH	.188-.375			10	49

Special nose piece required.

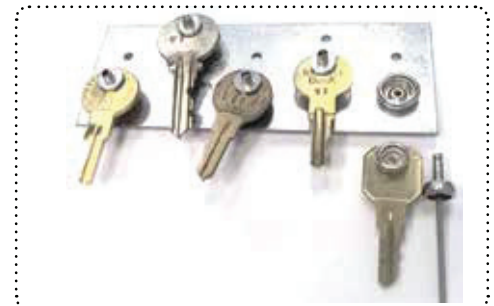

Call Rivet USA (a division of Cardinal Components) to Order or for Quote
800-236-3200 | info@cardinalcomponents.com | www.rivetusa.com