

RIVETKING® RIVINOX®

THE FOLLOWING PRODUCT IS COVERED UNDER THE FOLLOWING PATENT/TRADENAME 3,504,634

STAINLESS STEEL • HIGH SHEAR • REAR FLANGE RIVET

SPECIAL BLIND RIVETS

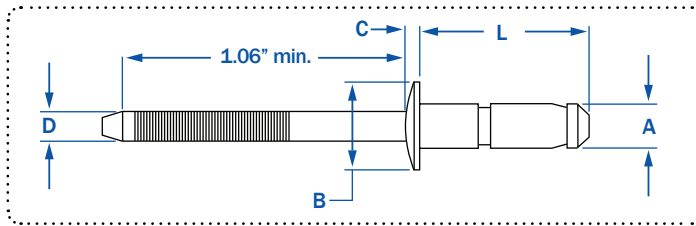

The Rivinox® rivet provides for an aesthetic secondary rear flange at the back side of the application. Perfect for thin sheet metals or plastics where rivet pull through is of concern. The mandrel will break nearly flush with the head and contains a locked mandrel to prevent vibration. 18-8 stainless steel constructions provides a corrosion resistant joint.

RIVET: 18-8 STAINLESS
MANDREL: 18-8 STAINLESS



PART NUMBER	RIVET SIZE	GRIP RANGE		LENGTH	HEAD DIA	HEAD HEIGHT	MANDREL DIA	HOLE SIZE	SHEAR	TENSILE
		MIN - MAX	NOM.	MAX.	MAX.	NOM.	MIN - MAX	LBS.F	LBS.F	
FBF - 0408 /RIVINOX	1/8"	.040 - .118	.350	.250	.043	.082	.129 - .134	719	450	
FBF - 0411 /RIVINOX		.118 - .197	.450							
FBF - 0414 /RIVINOX		.197 - .276	.540							
FBF - 0509 /RIVINOX	5/32"	.039 - .118	.400	.312	.060	.104	.161 - .169	1169	899	
FBF - 0512 /RIVINOX		.118 - .197	.480							
FBF - 0516 /RIVINOX		.197 - .276	.600							
FBF - 0611 /RIVINOX	3/16"	.059 - .138	.510	.375	.070	.127	.193 - .201	1236	1124	
FBF - 0614 /RIVINOX		.138 - .236	.610							
FBF - 0618 /RIVINOX		.236 - .335	.730							



SPECIAL SIZES AVAILABLE ON REQUEST

RIVETKING® RIVIBULB®

THE FOLLOWING PRODUCT IS COVERED UNDER THE FOLLOWING PATENT/TRADENAME 3,666,122

ALL STEEL • HIGH SHEAR • REAR FLANGE RIVET

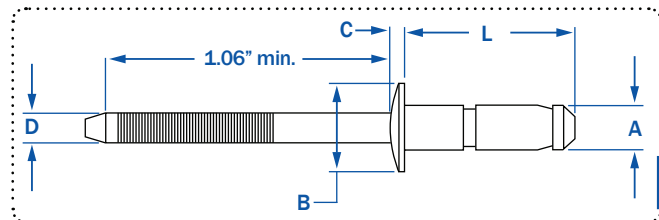

The Rivibulb® rivet provides for an aesthetic secondary rear flange at the back side of the application. Perfect for thin sheet metals or plastics where rivet pull through is of concern. The mandrel will break nearly flush with the head and contains a locked mandrel to prevent vibration. Trivalent Zinc Plated for ROHS compliance.

RIVET: C-1010 STEEL, TRIVALENT ZINC CLEAR PLATED
MANDREL: HIGH CARBON STEEL, TRIVALENT ZINC PLATED



PART NUMBER	RIVET SIZE	GRIP RANGE		LENGTH	HEAD DIA	HEAD HEIGHT	MANDREL DIA	HOLE SIZE	SHEAR	TENSILE
		MIN - MAX	NOM.	MAX.	MAX.	NOM.	MIN - MAX	LBS.F	LBS.F	
SBS - 0408 /RVB	1/8"	.039 - .118	.360	.268	.055	.083	.129 - .134	270	292	
SBS - 0411 /RVB		.118 - .197	.461							
SBS - 0414 /RVB		.197 - .276	.551							
SBS - 0509 /RVB	5/32"	.039 - .118	.410	.315	.059	.102	.161 - .169	539	629	
SBS - 0512 /RVB		.118 - .197	.510							
SBS - 0516 /RVB		.197 - .276	.620							
SBS - 0611 /RVB	3/16"	.059 - .138	.480	.378	.059	.126	.193 - .201	809	855	
SBS - 0614 /RVB		.138 - .236	.580							
SBS - 0618 /RVB		.236 - .335	.695							
SBS - M6X10 /RVB	6mm	.060 - .156	.413	.472	.078	.156	.240 - .248	945	1215	
SBS - M6X13 /RVB		.118 - .236	.532							
SBS - M6X16 /RVB		.236 - .354	.650							
SBS - M6X19 /RVB		.354 - .472	.768							



SPECIAL SIZES AVAILABLE ON REQUEST

