

RIVETKING® RIVBOLT™

THE FOLLOWING PRODUCT IS COVERED UNDER THE FOLLOWING PATENT/TRADENAME: 3,504,676

STEEL/ STEEL

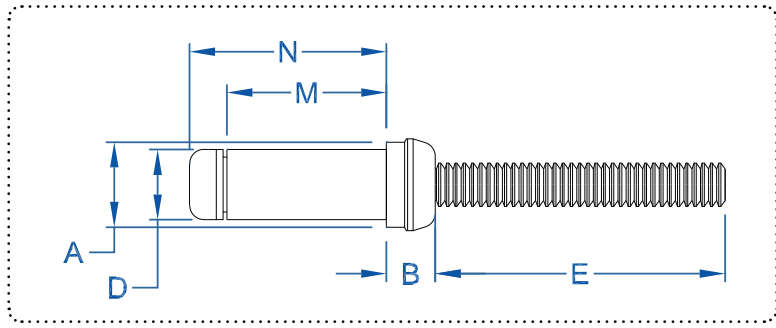

The RivetKing® RivBolt™ is ideal for high strength blind precision applications. The RivetKing® RivBolt™ is engineered for the truck/trailer, HVAC, automotive, rail car and structural racking systems. The RivetKing® RivBolt™ has a high shear and tensile value with clamp up for vibration resistance.

Tamper proof easy install from one side of the application with RivetKing® RK-756 or RK-745 tools. The RivetKing® RivBolt™ will break flush in the proper grip range.

MINIMUM VALUES IN NOMINAL GRIP**

| PART NUMBER | DIAMETER | GRIP RANGE | A | B | C | D | E | M | N | SHEAR | TENSILE | HOLE DIAMETER |
|-------------|----------|-------------|-----------|-----------|------|-----------|-------|-------|-------|-------|---------|---------------|
| | | | | | MAX. | | | REF. | MAX. | | | |
| RB6-2 | 3/16" | .093-.156 | .276-.286 | .152-.168 | .015 | .196-.206 | .785 | .376 | .500 | 2800 | 1800 | .208-.222 |
| RB6-3 | 3/16" | .157-.219 | .276-.286 | .152-.168 | .015 | .196-.206 | .785 | .439 | .562 | 2800 | 1800 | .208-.222 |
| RB6-4 | 3/16" | .220-.281 | .276-.286 | .152-.168 | .015 | .196-.206 | .785 | .501 | .625 | 2800 | 1800 | .208-.222 |
| RB6-5 | 3/16" | .282-.344 | .276-.286 | .152-.168 | .015 | .196-.206 | .785 | .564 | .687 | 2800 | 1800 | .208-.222 |
| RB6-6 | 3/16" | .345-.406 | .276-.286 | .152-.168 | .015 | .196-.206 | .785 | .626 | .750 | 2800 | 1800 | .208-.222 |
| RB6-7 | 3/16" | .407-.469 | .276-.286 | .152-.168 | .015 | .196-.206 | .785 | .689 | .812 | 2800 | 1800 | .208-.222 |
| RB6-8 | 3/16" | .470-.531 | .276-.286 | .152-.168 | .015 | .196-.206 | .785 | .751 | .875 | 2800 | 1800 | .208-.222 |
| RB6-9 | 3/16" | .532-.594 | .276-.286 | .152-.168 | .015 | .196-.206 | .785 | .814 | .937 | 2800 | 1800 | .208-.222 |
| RB6-10 | 3/16" | .595-.656 | .276-.286 | .152-.168 | .015 | .196-.206 | .785 | .876 | 1.000 | 2800 | 1800 | .208-.222 |
| RB6-11 | 3/16" | .657-.719 | .276-.286 | .152-.168 | .015 | .196-.206 | .785 | .939 | 1.062 | 2800 | 1800 | .208-.222 |
| RB6-12 | 3/16" | .720-.781 | .276-.286 | .152-.168 | .015 | .196-.206 | .785 | 1.001 | 1.125 | 2800 | 1800 | .208-.222 |
| RB8-2 | 1/4" | .093-.156 | .368-.380 | .205-.225 | .020 | .262-.275 | .860 | .460 | .620 | 5100 | 3250 | .277-.292 |
| RB8-3 | 1/4" | .157-.219 | .368-.380 | .205-.225 | .020 | .262-.275 | .860 | .523 | .682 | 5100 | 3250 | .277-.292 |
| RB8-4 | 1/4" | .220-.281 | .368-.380 | .205-.225 | .020 | .262-.275 | .860 | .585 | .745 | 5100 | 3250 | .277-.292 |
| RB8-5 | 1/4" | .282-.344 | .368-.380 | .205-.225 | .020 | .262-.275 | .860 | .648 | .807 | 5100 | 3250 | .277-.292 |
| RB8-6 | 1/4" | .345-.406 | .368-.380 | .205-.225 | .020 | .262-.275 | .860 | .710 | .870 | 5100 | 3250 | .277-.292 |
| RB8-7 | 1/4" | .407-.469 | .368-.380 | .205-.225 | .020 | .262-.275 | .860 | .773 | .932 | 5100 | 3250 | .277-.292 |
| RB8-8 | 1/4" | .470-.531 | .368-.380 | .205-.225 | .020 | .262-.275 | .860 | .835 | .995 | 5100 | 3250 | .277-.292 |
| RB8-9 | 1/4" | .532-.594 | .368-.380 | .205-.225 | .020 | .262-.275 | .860 | .898 | 1.057 | 5100 | 3250 | .277-.292 |
| RB8-10 | 1/4" | .595-.656 | .368-.380 | .205-.225 | .020 | .262-.275 | .860 | .960 | 1.120 | 5100 | 3250 | .277-.292 |
| RB8-11 | 1/4" | .657-.719 | .368-.380 | .205-.225 | .020 | .262-.275 | .860 | 1.023 | 1.182 | 5100 | 3250 | .277-.292 |
| RB8-12 | 1/4" | .720-.781 | .368-.380 | .205-.225 | .020 | .262-.275 | .860 | 1.085 | 1.245 | 5100 | 3250 | .277-.292 |
| RB10-4 | 5/16" | .188-.312 | .468-.478 | .266-.278 | .025 | .332-.346 | 1.285 | .695 | .875 | 8050 | 5200 | .348-.368 |
| RB10-6 | 5/16" | .313-.437 | .468-.478 | .266-.278 | .025 | .332-.346 | 1.285 | .820 | 1.000 | 8050 | 5200 | .348-.368 |
| RB10-8 | 5/16" | .438-.562 | .468-.478 | .266-.278 | .025 | .332-.346 | 1.285 | .945 | 1.125 | 8050 | 5200 | .348-.368 |
| RB10-10 | 5/16" | .563-.687 | .468-.478 | .266-.278 | .025 | .332-.346 | 1.285 | 1.070 | 1.250 | 8050 | 5200 | .348-.368 |
| RB10-12 | 5/16" | .688-.812 | .468-.478 | .266-.278 | .025 | .332-.346 | 1.285 | 1.195 | 1.375 | 8050 | 5200 | .348-.368 |
| RB10-14 | 5/16" | .813-.937 | .468-.478 | .266-.278 | .025 | .332-.346 | 1.285 | 1.320 | 1.500 | 8050 | 5200 | .348-.368 |
| RB10-16 | 5/16" | .938-1.062 | .468-.478 | .266-.278 | .025 | .332-.346 | 1.285 | 1.445 | 1.625 | 8050 | 5200 | .348-.368 |
| RB12-4 | 3/8" | .188-.312 | .553-.563 | .315-.327 | .030 | .393-.411 | 1.230 | .766 | .969 | 11100 | 7250 | .413-.435 |
| RB12-6 | 3/8" | .313-.437 | .553-.563 | .315-.327 | .030 | .393-.411 | 1.230 | .891 | 1.094 | 11100 | 7250 | .413-.435 |
| RB12-8 | 3/8" | .438-.562 | .553-.563 | .315-.327 | .030 | .393-.411 | 1.230 | 1.016 | 1.219 | 11100 | 7250 | .413-.435 |
| RB12-10 | 3/8" | .563-.687 | .553-.563 | .315-.327 | .030 | .393-.411 | 1.230 | 1.141 | 1.344 | 11100 | 7250 | .413-.435 |
| RB12-12 | 3/8" | .688-.812 | .553-.563 | .315-.327 | .030 | .393-.411 | 1.230 | 1.266 | 1.469 | 11100 | 7250 | .413-.435 |
| RB12-14 | 3/8" | .813-.937 | .553-.563 | .315-.327 | .030 | .393-.411 | 1.230 | 1.391 | 1.594 | 11100 | 7250 | .413-.435 |
| RB12-16 | 3/8" | .938-1.062 | .553-.563 | .315-.327 | .030 | .393-.411 | 1.230 | 1.516 | 1.719 | 11100 | 7250 | .413-.435 |
| RB12-18 | 3/8" | 1.063-1.187 | .553-.563 | .315-.327 | .030 | .393-.411 | 1.230 | 1.641 | 1.844 | 11100 | 7250 | .413-.435 |
| RB12-20 | 3/8" | 1.188-1.312 | .553-.563 | .315-.327 | .030 | .393-.411 | 1.230 | 1.766 | 1.969 | 11100 | 7250 | .413-.435 |

**These are minimum shear and tensile strengths, in pounds, of installed fasteners, when tested in a grip equal to or greater than one and one half the fastener diameter.

