

# RIVETKING® STEMLOCK®

THE FOLLOWING PRODUCT IS COVERED UNDER THE FOLLOWING PATENT/TRADEMARK: 3,504,665

STRUCTURAL BLIND RIVETS • STEEL/ ALUMINUM

STRUCTURAL BLIND RIVETS

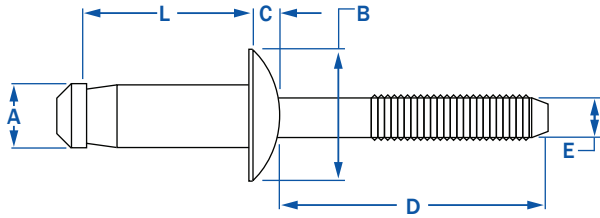

The Stemlock® is an advanced structural fastening solution that has among the highest shear and tensile values available because the mandrel is locked into the shear plane. The internal locking mechanism insures positive mandrel retention and will break flush with the head. The Stemlock® is designed to form a bearing surface flange at the rear side of the substrate. This rear flange is perfect for thin sheets or imperfect holes offering impressive clamp up forces without deforming the substrate.

AVAILABLE MATERIALS: ALL STEEL, ALL ALUMINUM DOME HEAD



RIVET SIZE	PART NUMBER	GRIP RANGE MIN. - MAX.	RIVET LENGTH MAX	STANDARD FLANGE			MANDREL DIA. DIA.	BACKSIDE CLEARANCE MIN.	SHEAR STRENGTH LBF	TENSILE STRENGTH LBF
				A	B	C				
				BODY DIA.	HEAD DIA. MAX.	HEAD HEIGHT MAX.				
1/4"	STMS-0812	.068 - .138	.539	.263 .271	.530	.110	N/R	.480	2,360	1,978
	STMS-0813	.110 - .189	.590						2,698	
	STMS-0814	.132 - .211	.612						2,810	
	STMS-0815	.189 - .268	.669						2,810	
	STMS-0817	.268 - .346	.747						3,147	
	STMS-0818	.295 - .374	.775						3,372	
	STMS-0819	.346 - .425	.826						3,597	
	STMS-0821	.425 - .504	.905						3,597	
1/4"	STMA-0812	.068 - .138	.539	.263 .271	.530	.110	N/R	.480	1,124	600
	STMA-0813	.110 - .189	.590						1,349	
	STMA-0814	.132 - .211	.612						1,394	
	STMA-0815	.189 - .268	.669						1,460	
	STMA-0817	.268 - .346	.747						1,574	
	STMA-0818	.295 - .374	.775						1,574	
	STMA-0819	.346 - .425	.826						1,574	
	STMA-0821	.425 - .504	.905						1,574	



Call Rivet USA (a division of Cardinal Components) to Order or for Quote  
800-236-3200 | info@cardinalcomponents.com | www.rivetusa.com